

TK Cable Guides

TK Cable Guide is designed to protect power, control cables mounted to a movable chassis from entangling, twisting or damage from cuts, kinks during chassis extension, retraction and storage. Easy length tuning. Please consult with us other profiles available.

! Caution

Read these instructions before use

- Do not use in the different usage other than guiding the cables.
- Do not mount on the cable guide. It may break and fall off.
- Please follow below important procedure when assembling, disassembling, and having maintenance of the cable guide.

- Fix the cable guide and the attaching components not to move freely. Otherwise, cable guide may automatically move by its weight, and may fall down.
- Do not put hand near the bending part. Otherwise, your hand may caught up.
- Have applicable wearing, protectors (safety glasses, gloves, safety shoes etc.) .
- TURN OFF the electric power. Do not conduct any procedure with the electric power ON until the assembly completed.
- Assemble the cable guide according to the instruction.
- Assembly should be done with the skilled worker.

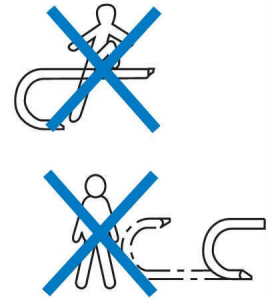

- Use the cable guide with the understanding of the structure and specifications.
- Check the cable guide appearance before assembly to see if there's any damage due to the shipment.
- Make a periodic maintenance.

Cable Guide 20 Series

Specification

- Fixed end and moving end brackets are united.
- Material / ABS UL94HB equivalent
- Weight / approx 2.7 g /link
- Color / White

[Ordering]

TK0200,15BR20,** Link qty

ex) TK0200, 15BR20, 25
 ↑ ↑ ↑
 Inner width 15 Link qty 25
 (Approx 40 Links to be 1m length)

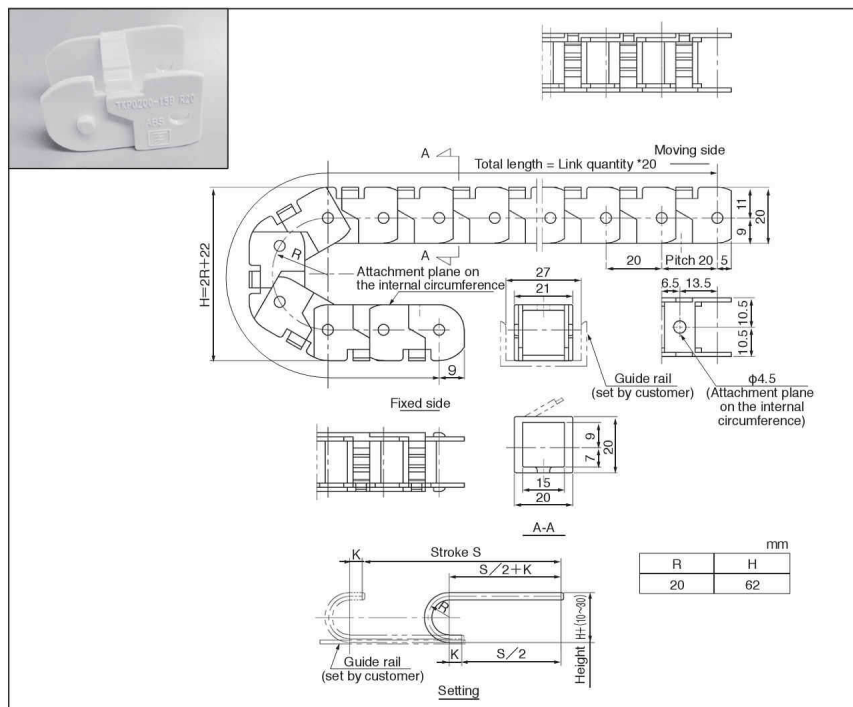

Cable Guide 25 Series

Specification

- Fixed end and moving end brackets are available.
- Material / Polyamide UL94HB equivalent
- Weight / 25-15 approx 5g/link
25-20 approx 5.3g/link
- Color / Black

[Ordering]

Designate, Inner width, R, number of link

R28 or 37, or 50

ex) TK0250, 15BR28, 25

Inner width 15 or 20 # of Link
(Approx 40 Links for 1m)

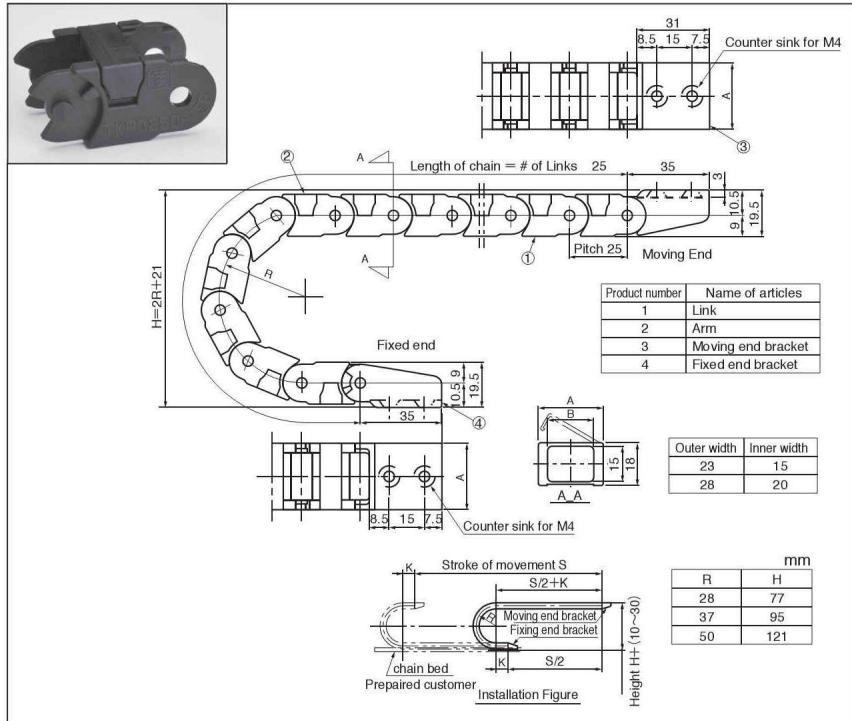

Cable Guide 35 Series

Specification

- Fixed end and moving end brackets are available.
- Material / ABS UL94V1 equivalent
- Weight / approx 9g/link
- Color / Light gray

[Ordering]

Name of articles : Cable Guide

CG35 - 40 - Number of link
(Approx 29 Links for 1m)

