

Soft Absorber

FA-4225B/FA-4250B/FA-4225SL/FA-4250SL/FA-4275B Series

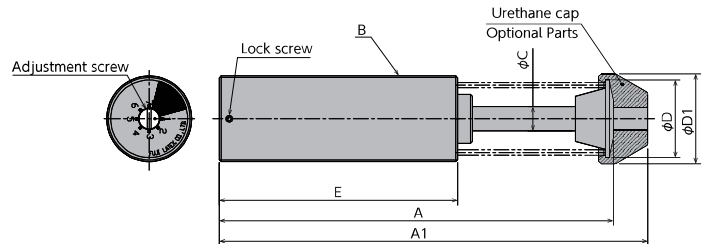

*The absorber's main unit does not come with nuts.

Dimensions

Model	A	A1	B	C	D	D1	E
FA-4225B3/SL-C	144	162	M42×1.5	12	38	44	92
FA-4250B3/SL-C	195	213					118
FA-4275B3-C	246	264					143

Specifications

Model	Stroke mm	Max. absorption energy J (kgf·m)	Max. equivalent mass kg (kgf)	Range of impact rate m/s	Max. drag N (kgf)	Max.cycle rate cycle/min	Absorption energy per minute J/min (kgf·m/min)	ecovering power of the piston rod N (kgf)	Operating temperature ℃	Mass g
FA-4225B3-C	25	260(26,5)	3,400(3,400)	0.3~3.0	31,590 (3,223)	20	1,858(190)	120(12.2)	-5~70	795
FA-4225SL-C			81,400(81,400)	0.05~0.5		10				
FA-4250B3-C	50	520(53.1)	6,500(6,500)	0.3~3.0		10	2,372(242)			1,020
FA-4250SL-C			162,700(162,700)	0.05~0.5		5				
FA-4275B3-C	75	780(79.6)	9,700(9,700)	0.3~3.0		6	3,345(341)			1,240

Precautions for Use

- * Do not use this product without carefully reading the attached owner's manual.
- * Ensure that an external stopper (Stopper nut OP-020M42) is also used.
- * Do not turn the oil inlet screw located at the bottom of the main unit.
- * Ensure that sufficient mounting strength is secured for this product. (As a guideline, it should be 2 to 3 times the maximum drag listed in the catalogue.)
- * Do not use this product in a vacuum or a location where it may come in contact with oil.
- * Ensure that an eccentric load is not applied to the soft absorber (Allowable eccentric angle: within $\pm 2.5^\circ$)
- * The urethane caps are consumables. Please replace them when necessary.

Adjustment Method

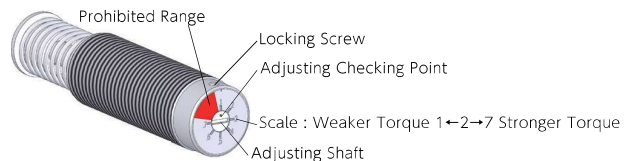

- * To adjust, turn the adjustment knob located at the bottom of the main unit.
- * Because the adjustment can be done in an analog manner, a value between two integers on the indicator can be set.
- * Once the adjustment is complete, secure with a lock screw using the attached hex wrench.

●Products specification might be changed without notice.

Optional Parts

Nut OP-M42

Model
OP-M42

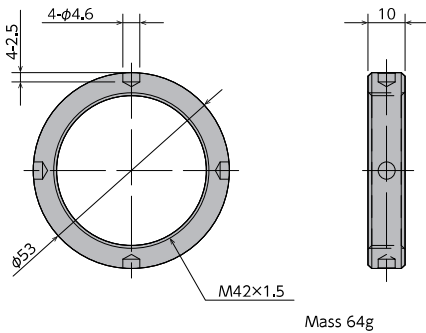

Square flange OP-040 M42SF

Model
OP-040M42SF

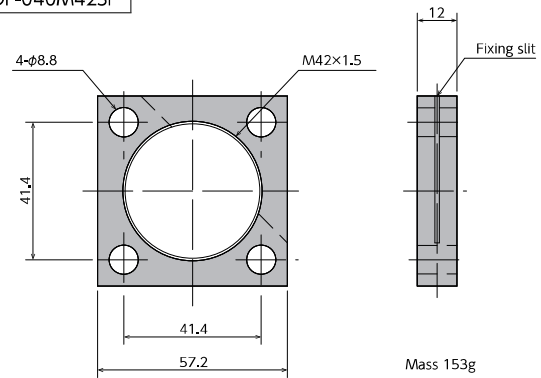

Stopper nut OP-020 M42

Model
OP-020M42

● Once the attachment site is determined, use the main unit's nut to securely fasten in place.

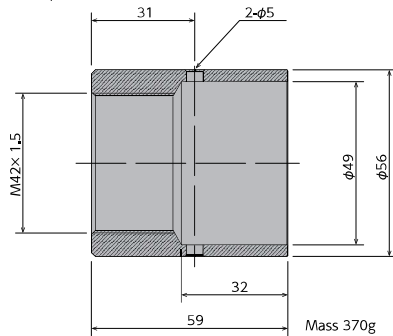

Rectangle flange OP-040 M42RF

Model
OP-040M42RF

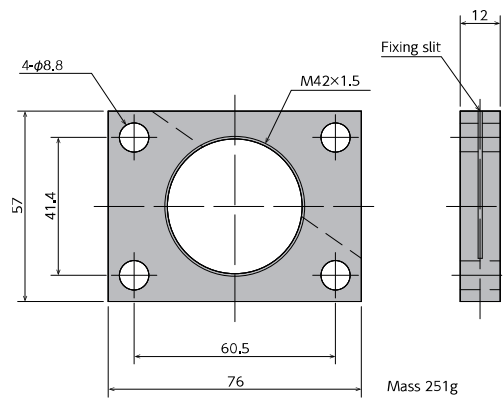

Urethane cap OP-090 M42A

Model
OP-090M42A

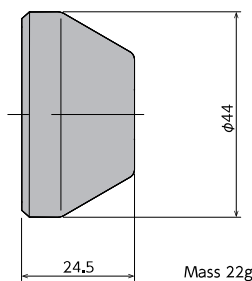

Side mount OP-M42SM

Model
OP-M42SM

* Side mount is sold as a set of two.
* Recommended bolt: M8 X 50 hexagon socket head bolt

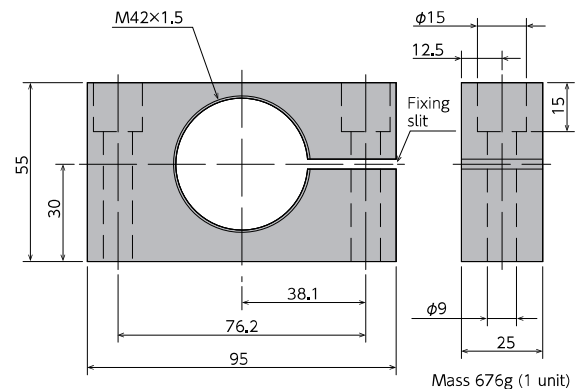

Soft Absorber

Fixed Type Adjustable type Self-adjusting

FA-4225B/FA-4225SL/FA-4250B/FA-4250SL Series

RoHS Compliant

●Products specification might be changed without notice.

Optional Parts

Eccentric angle adaptor OP-010M4225/M4250

Model
OP-010M4225
OP-010M4250

- Screw the eccentric angle adaptor into the main unit until the cap for the eccentric angle and the piston rod form a tight connection.
While maintaining this position, fasten the main unit's nut until secured.
- Use the eccentric angle adaptor when the eccentric angle is 2.5° or larger.
- The main unit can also be used as a stopper.
- Use it with a capless soft absorber.
- The maximum operating eccentric angle with an eccentric angle adaptor is $\pm 10^\circ$.
- Nut for unit is not inclusive.
- Not usable for FA-4250YD-C, FWM-4250YBD-C.
- The caps and the guides for inclined use are not unbundled.

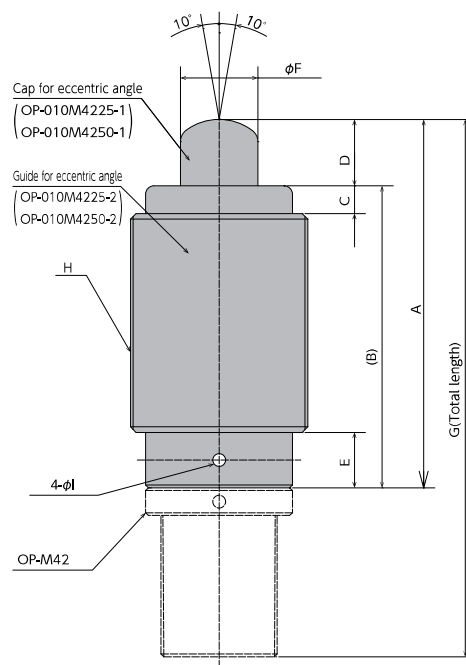

Model	A	B	C	D	E	ϕF	G	H	ϕI	Weight g
OP-010M4225	133	109	10	24	20	28	194	M64×2	4.6	1,600
OP-010M4250	203	154		49			290			2,500

Nut OP-M64

Model
OP-M64

- Usable as the nut for eccentric angle adaptor

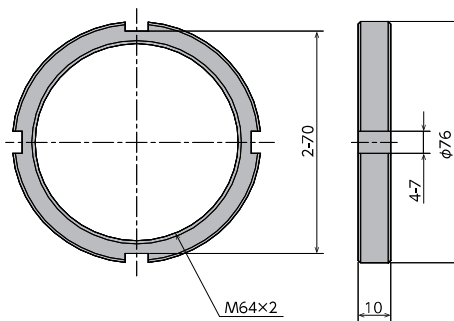

Mass 100g

Soft Absorber

Fixed Type Adjustable type Self-adjusting

FA-4250YD/FWM-4250YBD Series

RoHS Compliant

●Products specification might be changed without notice.

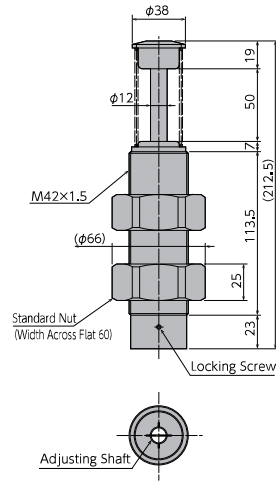



Specifications

Model	Stroke mm	Max. absorption energy J (kgf·m)	Max. equivalent mass kg (kgf)	Range of impact rate m/s	Orifice type
FA-4250YD-C	50	441 (45)	390 (390)	0.7~3	Multiple-orifice type
FWM-4250YBD-C			3,500 (3,500)	0.3~2	Multiple-varying orifice type

Common Specifications

Max. drag	N(kgf)	27,030 (2,758)	Operating temperature	℃	-5~70
Max. cycle rate	cycle/min	10	Mass : C type	g	1,940
Max. absorption energy per minute	J/min (kgf·m/min)	2,744 (280)			
Recovering power of the piston rod	N(kgf)	83.3 (8.5) or lower			

Selection Guideline FA-4250 series has the following three patterns of absorption characteristics depending on the orifice type. Please use the following information as a guideline when making your selection.

Orifice type	Multiple-orifice type	Multiple-varying orifice type
Model number	FA-4250YD series	FWM-4250YBD series
Application	For high-speed	For medium speed, in particular with a pneumatic cylinder
Absorption characteristics		

Precautions for Use

- * Do not use this product without carefully reading the attached owner's manual.
- * We recommend that you use it with an external stopper.
- * Ensure that sufficient mounting strength is secured for this product. (As a guideline, it should be 2 to 3 times the maximum drag listed in the catalogue.)
- * Do not use this product in a vacuum or a location where it may come in contact with oil.
- * Ensure that an eccentric load is not applied to the soft absorber. (Allowable eccentric angle: $\pm 2.5^\circ$)

Adjustment Method

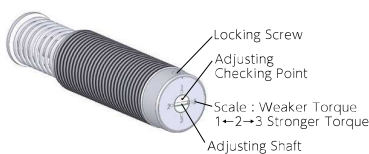

- * To adjust, turn the adjustment knob with a slotted screw driver.
- * Because the adjustment can be done in an analog manner, a value between two integers on the indicator can be set.
- * It does not have a lock screw for locking the adjusted setting.

Optional Parts

Square flange OP-040YB

Applicable Models	Model
FA-4250YD	OP-040YB
FWM-4250YBD	

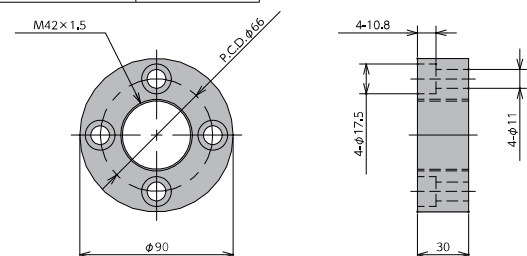

Standard nuts are sold separately as well.

Applicable Models	Model
FA-4250YD	M42 nut
FWM-4250YBD	

New products

1 Soft Absorber

2 Rotary Damper

3 Magnum Series

4 Speed Controller

5 Helical Isolator

6 Model Selection Form